



# Prairie Winds Development

The newest development in Mankato offers proposed sites suitable for a variety of uses including retail, office, hospitality/restaurant and childcare. Current users include Kwik Trip, Nupa and Hyland Dental. The future multi-family housing development which will bring 180-200 units of new luxury multi-family. The approximately 35 acre development is adjacent to existing and planned residential neighborhoods as well as existing retail development.

PID: R01.09.15.303.001 R01.09.15.301.001 R01.09.15.301.002  
R01.09.15.302.001 R01.09.15.302.002 R01.09.15.302.003

## CONTACT

**Chad Behnken | CCIM Vice President/Principal**  
chad@hamiltonmnre.com  
O: 507-281-1002 ext 107 | M: 507-251-7667



# Development Map



## CONTACT

**Chad Behnken | CCIM Vice President/Principal**  
 chad@hamiltonmnre.com  
 O: 507-281-1002 ext 107 | M: 507-251-7667





# Development Map

- A** Madison E. Center
- B** Again Thrift Store
- C** Jiffy Lube
- D** Hobby Lobby
- E** River Hills Mall
- F** Cub Foods
- G** Shopko
- H** Baymount Inn & Suites
- I** Best Buy
- J** Snell Motors
- K** Hyvee
- L** Holiday Inn Express
- M** Open Door Health Center
- N** Aldi
- O** Retail Center
- P** Luther Mankato Honda
- Q** Mankato Chevrolet
- R** Sams Club
- S** Walmart
- T** Mankato Heights Plaza
- U** Kohl's Mankato
- V** Mankato Armory
- W** Mayo Clinic Urgent Care
- X** Kennedy Elementary School
- Y** Mankato East Senior High School



## CONTACT

**Chad Behnken | CCIM Vice President/Principal**  
 chad@hamiltonmnre.com  
 O: 507-281-1002 ext 107 | M: 507-251-7667



# Plat Map

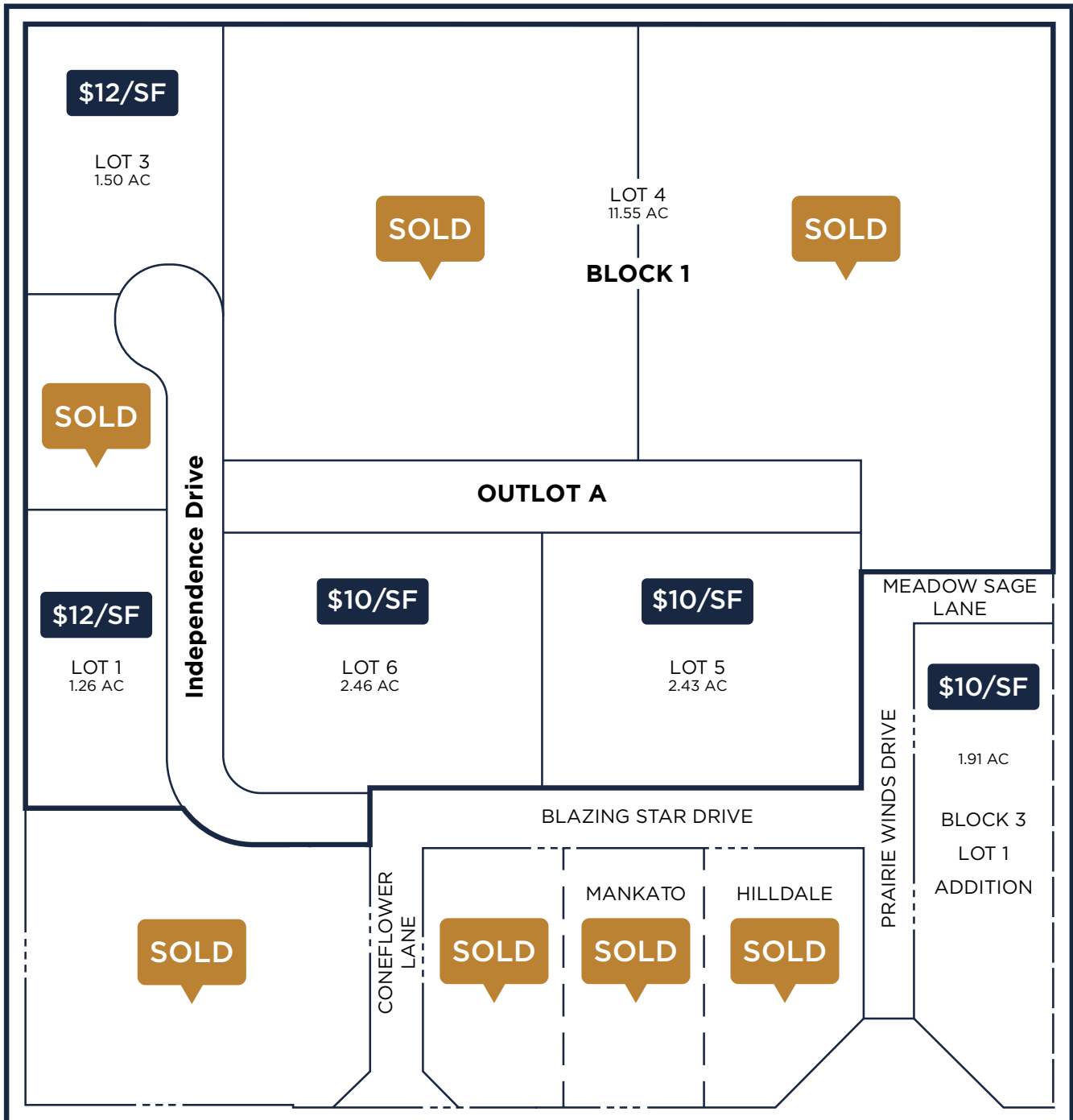

## CONTACT

**Chad Behnken | CCIM Vice President/Principal**  
 chad@hamiltonmnre.com  
 O: 507-281-1002 ext 107 | M: 507-251-7667